



RV系列蜗轮减速机

RV series worm-gear reducer



CV. ALED KARYA BERSAMA

因专业 而精彩

Outstanding by virtue of professional

■ ISO9001 国际质量体系认证



■ ISO9001 国际质量体系认证



RV系列蜗轮减速机 RV series worm-gear reducer

▶ RV系列产品代号编写方法 Compiling metho of RV series product code number

NMRV 063 - F1 - AS - 50 - Y0.12 - B3

NMRV—配法兰输入
Flange-style NMRV

NRV—配轴输入
input shaft-style NRV

机座规格(中心距)

F1、F2—附加法兰
Additional flange code:F1,F2

无法兰省略
Omit expression without flange

安装方位
Mounting posiyion

电机类型及功率
Elecyric motor type and power

减速比 ratio

AS----附加单向输出轴
Additonal single ouput shaft:AS

AB----附加双向输入轴
Additional single output shaft:AB

VS----蜗杆延伸轴
Estension gear-shaft:VS

T---- 附加转矩臂 Additional torgue arm:T

无标志=不配输出轴



总体简介

结构特点

优质铝合金铸造箱体，适应全方位的万能安装配置；充分的冷却筋条，使机体具有优良的热传导性能；从030--130共8种机座规格；传递功率范围从60W--7.5kW；速比范围大，每个机座具有从5：1到100：1的12种减速比；精密磨削加工的硬齿面传动蜗杆，效率高、输出扭矩大；低噪声平稳运转，能适合在恶劣环境中长期连续工作；重量轻，机械强度高；模块化组合使RV减速机的传动比拓展至：i=5--3200。

主要材料

外壳：铝合金(机座：030--090)，铸铁(机座：110--130)；蜗杆：20Cr钢或40cr热处理(精磨后保持齿面硬度HRC55-HRC60，硬层厚度 > 0.5mm)；蜗轮：特殊配制的耐磨镍青铜；蜗轮芯采用QT600与45#钢

涂漆

1.抛丸处理后，喷塑处理，有蓝色与灰白色可选。

铝合金箱体

2.铸铁箱体：喷涂烘烤漆。

Overview

Structural Features

The high-quality aluminum alloy casting enclosure is suitable for all-dimensional universal installation configurations; the fully cooled ribs contribute an excellent thermal conductivity to the housing; there are altogether 8 seat specifications from 030 to 130; the transmission power ranges from 60W to 7.5kW; the speed ratio coverage is wide because every single seat has 12 speed reduction ratios from 5:1 to 100:1; the hard tooth surface transmission worm with precision grinding is featured by its high efficiency and big output torque; with low-noise and stable operation, it's applicable for long-term continuous operation in a harsh environment; it's light in weight and high in mechanical strength; and the modular combination makes the transmission ratio of RV speed reducers extend to: i=5--3200.

Main Materials

Enclosure: aluminum alloy (seat: 030--090), cast iron (seat: 110--130); worm: 20Cr steel or 40Cr heat treatment (keeping the tooth surface hardness between HRC55 and HRC60 and the hard coating thickness >0.5mm after precision grinding); worm gear: anti-wear nickel bronze with a special formula; worm gear core: QT600 and 45# steel.

Painting

1. Plastic spraying treatment after shot blasting, optional for blue and offwhite.

Aluminum alloy enclosure

2. Cast iron enclosure: spray coating of baking paint.



因专业而精彩
Outstanding by virtue of professional



RV系列蜗轮减速机 | RV series worm-gear reducer

▶ 技术参数 Technical data

转动比 Ratio	输出转速 Output speed r/min	型号 Type	电机功率 Motor power (kw)	输出转矩 Output torque (N.m)
7.5	187	NMRV030	0.12	5
			0.18	8
			0.25	11
		NMRV040	0.37	16
			0.55	25
		NMRV050	0.75	34
			1.1	50
		NMRV063	1.5	68
			2.2	100
		NMRV075	3	137
			2.2	100
		NMRV090	3	138
			4	184
		NMRV110	5.5	253
			7.5	345
NMRV130	5.5	257		
	7.5	349		
10	140	NMRV030	0.12	7
			0.18	10
		NMRV040	0.25	14
			0.37	21
		NMRV050	0.37	22
			0.55	32
		NMRV063	0.75	44
			1.1	65
		NMRV075	1.5	89
			1.5	90
		NMRV090	2.2	132
			3	180
			2.2	134
		NMRV110	3	182
			4	243
4	243			
NMRV130	5.5	334		
	7.5	455		
NMRV130	5.5	334		
	7.5	445		
15	93	NMRV030	0.12	9
			0.18	14
		NMRV040	0.25	21
			0.37	31
		NMRV050	0.37	31
			0.55	46
			0.75	63
		NMRV063	0.75	64
			1.1	93
			1.5	127
		NMRV075	1.1	96
			1.5	130
			2.2	191
		NMRV090	2.2	194
			3	264
4	352			

转动比 Ratio	输出转速 Output speed r/min	型号 Type	电机功率 Motor power (kw)	输出转矩 Output torque (N.m)
15	93	NMRV110	3	264
			4	352
			5.5	484
		NMRV130	5.5	490
			7.5	668
20	70	NMRV030	0.12	12
			0.18	18
		NMRV040	0.25	27
			0.37	39
		NMRV050	0.25	27
			0.37	40
			0.55	59
		NMRV063	0.55	61
			0.75	83
			1.1	122
		NMRV075	1.1	123
			1.5	168
			1.5	172
		NMRV090	2.2	252
			3	344
2.2	255			
NMRV110	3	348		
	4	464		
	5.5	645		
NMRV130	7.5	880		
	0.12	14		
25	56	NMRV030	0.18	21
			0.25	32
		NMRV040	0.25	32
			0.37	48
		NMRV050	0.55	71
			0.55	73
			0.75	100
		NMRV063	0.75	102
			0.75	102
			1.1	150
		NMRV075	1.5	205
			1.5	210
			2.2	308
		NMRV090	2.2	315
			3	430
4	573			
NMRV110	4	573		
	5.5	788		
	0.12	16		
NMRV030	0.12	17		
	0.18	26		
	0.25	36		
NMRV040	0.25	36		
	0.37	55		
	0.55	81		
NMRV050	0.55	83		
	0.75	114		



ISO9001 国际质量体系认证



RV系列蜗轮减速机 | RV series worm-gear reducer

技术参数 Technical data

转动比 Ratio	输出转速 Output speed r/min	型号 Type	电机功率 Motor power (kw)	输出转矩 Output torque (N.m)
30	47	NMRV063	1.1	167
		NMRV075	1.1	148
			1.5	233
		NMRV090	1.5	239
			2.2	351
		NMRV110	2.2	356
			3	485
			4	647
40	35	NMRV130	5.5	900
		NMRV030	0.12	17
			0.12	21
		NMRV040	0.18	32
			0.18	33
		NMRV050	0.25	46
			0.37	68
			0.37	71
		NMRV063	0.55	105
			0.75	143
			0.55	108
			0.75	147
		NMRV075	1.1	216
			1.1	225
1.5	307			
NMRV090	1.5	319		
	2.2	468		
	3	638		
	2.2	468		
NMRV110	3	638		
	4	851		
	NMRV130	3	638	
		4	851	

转动比 Ratio	输出转速 Output speed r/min	型号 Type	电机功率 Motor power (kw)	输出转矩 Output torque (N.m)
60	23	NMRV040	0.12	28
			0.12	29
		NMRV050	0.18	43
			0.25	60
			0.25	63
		NMRV063	0.37	94
			0.37	98
		NMRV075	0.55	146
			0.75	200
			0.75	212
		NMRV090	1.1	311
			1.1	324
NMRV110	1.5	442		
	2.2	648		
NMRV130	3	884		
	3	884		
80	18	NMRV030	0.09	12
			0.09	26
		NMRV040	0.12	34
			0.12	35
		NMRV050	0.18	52
			0.18	52
		NMRV063	0.25	78
			0.37	115
			0.37	121
		NMRV075	0.55	180
			0.55	189
		NMRV090	0.75	258
			0.75	258
		NMRV110	0.55	201
			0.75	274
			1.1	402
		NMRV130	1.1	408
			1.5	557
2.2	816			
100	14	NMRV030	0.06	12
			0.09	29
		NMRV040	0.09	29
			0.12	40
		NMRV050	0.12	40
			0.25	87
		NMRV063	0.25	87
			0.37	139
		NMRV075	0.37	139
			0.55	221
		NMRV090	0.55	221
			0.75	322
NMRV110	1.1	473		
	1.1	485		
NMRV130	1.5	655		
	1.5	655		



因专业而精彩
Outstanding by virtue of professional



RV系列蜗轮减速机 | RV series worm-gear reducer

▶ 技术参数 Technical data

转动比 Ratio	输出转速 Output speed r/min	型号 Type	电机功率 Motor power (kw)	输出转矩 Output torque (N.m)
7.5	187	NMRV030	0.12	5
			0.18	8
			0.25	11
		NMRV040	0.37	16
			0.55	25
		NMRV050	0.75	34
			1.1	50
		NMRV063	1.5	68
			2.2	100
		NMRV075	3	137
			2.2	100
		NMRV090	3	138
			4	184
		NMRV110	5.5	253
			7.5	345
NMRV130	5.5	257		
	7.5	349		
10	140	NMRV030	0.12	7
			0.18	10
		NMRV040	0.25	14
			0.37	21
		NMRV050	0.37	22
			0.55	32
		NMRV063	0.75	44
			1.1	65
		NMRV075	1.5	89
			1.5	90
		NMRV090	2.2	132
			3	180
		NMRV110	2.2	134
			3	182
		NMRV130	4	243
4	243			
NMRV110	5.5	334		
	7.5	455		
NMRV130	5.5	334		
	7.5	445		
15	93	NMRV030	0.12	9
			0.18	14
		NMRV040	0.25	21
			0.37	31
		NMRV050	0.37	31
			0.55	46
		NMRV063	0.75	63
			0.75	64
		NMRV063	1.1	93
			1.5	127
		NMRV075	1.1	96
			1.5	130
		NMRV090	2.2	191
			2.2	194
		NMRV090	3	264
4	352			

转动比 Ratio	输出转速 Output speed r/min	型号 Type	电机功率 Motor power (kw)	输出转矩 Output torque (N.m)
15	93	NMRV110	3	264
			4	352
			5.5	484
			5.5	490
			7.5	668
20	70	NMRV030	0.12	12
			0.18	18
		NMRV040	0.25	27
			0.37	39
		NMRV050	0.25	27
			0.37	40
		NMRV063	0.55	59
			0.55	61
		NMRV063	0.75	83
			1.1	122
		NMRV075	1.1	123
			1.5	168
		NMRV090	1.5	172
			2.2	252
		NMRV110	3	344
2.2	255			
NMRV130	3	348		
	4	464		
NMRV130	5.5	645		
	7.5	880		
25	56	NMRV030	0.12	14
			0.18	21
		NMRV040	0.25	32
			0.25	32
		NMRV050	0.37	48
			0.55	71
		NMRV063	0.55	73
			0.75	100
		NMRV075	0.75	102
			1.1	150
		NMRV090	1.5	205
			1.5	210
		NMRV110	2.2	308
			2.2	315
		NMRV130	3	430
4	573			
NMRV130	4	573		
	5.5	788		
30	47	NMRV030	0.12	16
			0.12	17
		NMRV040	0.18	26
			0.25	36
		NMRV050	0.25	36
			0.37	55
		NMRV063	0.55	81
			0.55	83
		NMRV063	0.75	114



因专业而精彩
Outstanding by virtue of professional



RV系列蜗轮减速机 RV series worm-gear reducer

安装尺寸 Mounting dimensions

NMRV型尺寸
NMRV Type dimensions

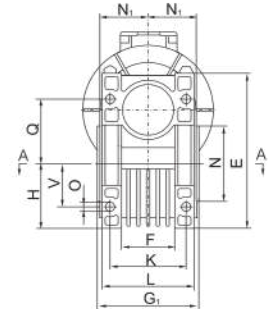
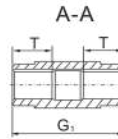
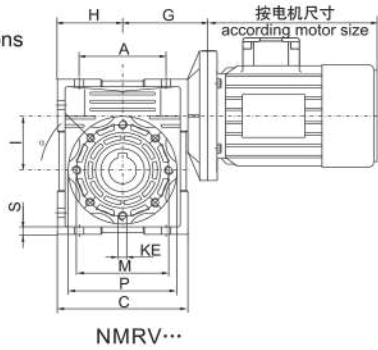

NMRV...

NRV型尺寸
NRV Type dimensions

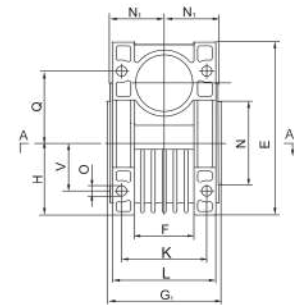
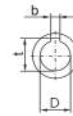
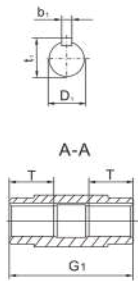
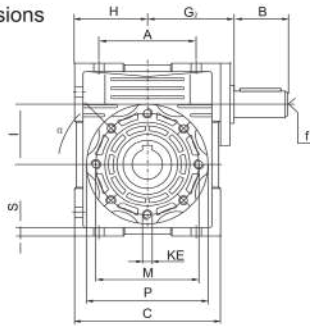

NRV...

附加法兰安装尺寸 Additional flange mounting dimensions

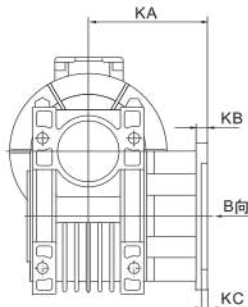

NMRV...-F₁

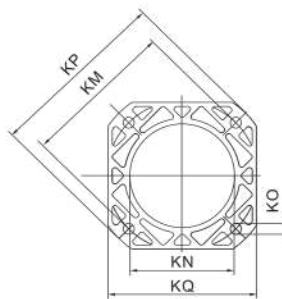

NMRV030-090

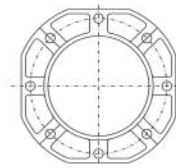

NMRV110-130

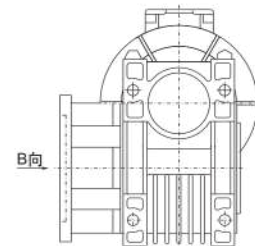

NMRV...-F₂

附加单向及双向输出轴安装尺寸 Additional single and double output shaft mounting dimensions

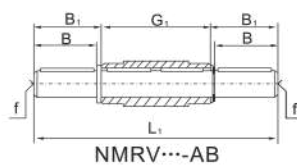

NMRV...-AB

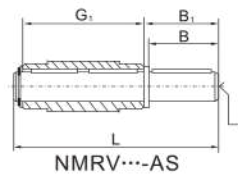

NMRV...-AS

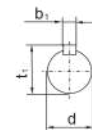



因专业而精彩
Outstanding by virtue of professional



RV系列蜗轮减速机 | RV series worm-gear reducer

► 安装尺寸 Mounting dimensions

单向及双向输出轴尺寸表 Table of single and double output shaft dimensions

型号 Type	尺寸 Dimensions								
	D	B	B ₁	G ₁	L	L ₁	f	b ₁	t ₁
NMRV030	14g6	30	32.5	63	102	128	M6	5	16
NMRV040	18h6	40	43	78	128	164	M6	6	20.5
NMRV050	25h6	50	53.5	92	153	199	M10	8	28
NMRV063	25h6	50	53.5	112	173	219	M10	8	28
NMRV075	28h6	60	63.5	120	192	247	M10	8	31
NMRV090	35h6	80	84.5	140	234	309	M12	10	38
NMRV110	42h6	80	84.5	155	249	324	M16	12	45
NMRV130	45h6	80	85	170	265	340	M16	14	48.5

延伸蜗杆轴尺寸 Extension gear-shaft dimensions

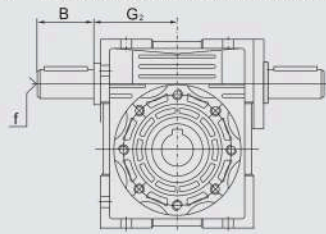

NRV...-VS

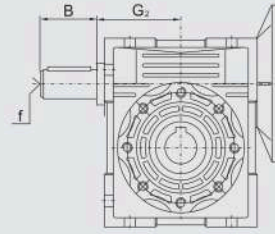
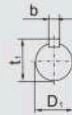

NMRV...-VS

型号 Type	尺寸 Dimensions					
	G ₂	d _(j6)	B	f	b ₁	t ₁
NMRV030	45	9	20	-	3	10.2
NMRV040	53	11	23	-	4	12.5
NMRV050	64	14	30	M6	5	16
NMRV063	75	19	40	M6	6	21.5
NMRV075	90	24	50	M8	8	27
NMRV090	108	24	50	M8	8	27
NMRV110	135	28	60	M10	8	31
NMRV130	155	30	80	M10	8	33

转矩臂尺寸 Torque arm dimensions

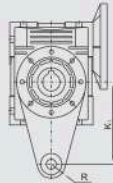

NMRV...-T

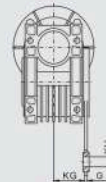

型号 Type	尺寸 Dimensions				
	K ₁	G	KG	KH	R
NMRV030	85	14	24	8	15
NMRV040	100	14	31.5	10	18
NMRV050	100	14	38.5	10	18
NMRV063	150	14	49	10	18
NMRV075	200	25	47.5	20	30
NMRV090	200	25	57.5	20	30
NMRV110	250	30	62	25	35
NMRV130	250	30	69	25	35



■ ISO9001 国际质量体系认证



RV系列蜗轮减速机 | RV series worm-gear reducer

安装方位 Mounting position

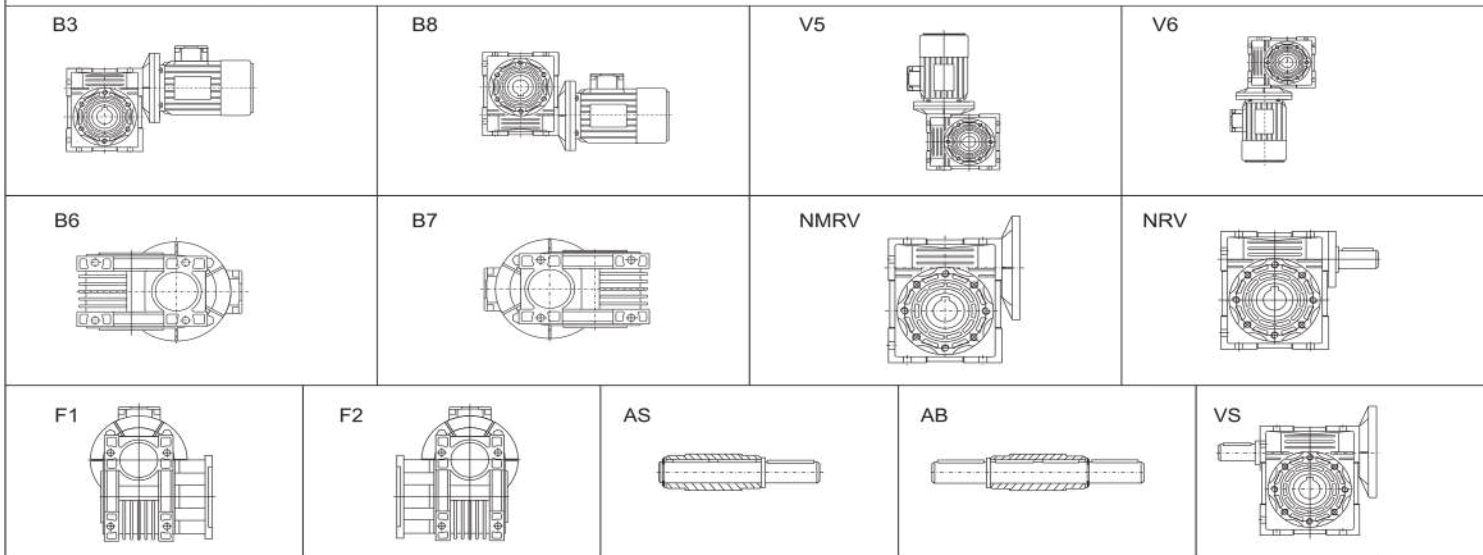

注：1、用户要求特殊定制时，请详细说明。2、本系列减速机可以双级串联使用。
 Note: 1、Please sign clearly if customers need special design. 2、This series reducer can be added in series.

RV减速机的电机配合接口 Motor fitting interface of RV speed reducers

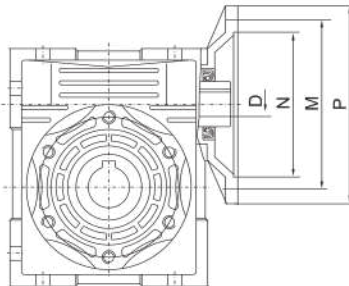

	PAME IEC	N		M		P		5	7.5	10	15	20	25	30	40	50	60	80	100
		B5	B14	B5	B14	B5	B14	D											
NMRV 030	56B5/B14	80	50	100	65	120	80	9	9	9	9	9	9	9	9	9	9	9	-
	63B5/B14	95	60	115	75	140	90	11	11	11	11	11	11	11	11	11	11	11	-
NMRV 040	56B5	80	-	100	-	120	-	-	-	-	-	-	-	-	-	9	9	9	9
	63B5/B14	95	60	115	75	140	90	11	11	11	11	11	11	11	11	11	11	11	11
	71B5/B14	110	70	130	85	160	105	14	14	14	14	14	14	14	14	-	-	-	-
NMRV 050	80B5/B14	130	80	165	100	200	120	19	19	19	19	-	-	-	-	-	-	-	-
	63B5	95	-	115	-	140	-	-	-	-	-	-	-	-	-	11	11	11	11
	71B5/B14	110	70	130	85	160	105	14	14	14	14	14	14	14	14	14	14	14	-
NMRV 063	80B5/B14	130	80	165	100	200	120	19	19	19	19	19	19	19	19	19	19	19	19
	71B5/B14	110	70	130	85	160	105	-	-	-	-	-	-	-	-	14	14	14	14
	90B5/B14	130	95	165	115	200	140	-	24	24	24	24	24	24	-	-	-	-	-
NMRV 075	80B5/B14	130	80	165	100	200	120	-	-	-	-	-	-	-	19	19	19	19	19
	90B5/B14	130	95	165	115	200	140	-	24	24	24	24	24	24	24	-	-	-	-
	100B5/B14	180	110	215	130	250	160	-	28	28	28	-	-	-	-	-	-	-	-
NMRV 090	112B5/B14	180	110	215	130	250	160	-	28	28	28	-	-	-	-	-	-	-	-
	80B5/B14	130	80	165	100	200	120	-	-	-	-	-	-	-	-	19	19	19	19
	90B5/B14	130	95	165	115	200	140	-	-	-	-	-	24	24	24	24	24	24	-
NMRV 110	100B5/B14	180	110	215	130	250	160	-	28	28	28	28	28	28	28	28	28	28	28
	90B5	130	-	165	-	200	-	-	-	-	-	-	-	-	-	24	24	24	24
	112B5	180	-	215	-	250	-	-	28	28	28	28	28	28	-	-	-	-	-
NMRV 130	132B5	230	-	265	-	300	-	-	38	38	38	38	-	-	-	-	-	-	-
	90B5	130	-	165	-	200	-	-	-	-	-	-	-	-	-	-	-	-	24
	100B5	180	-	215	-	250	-	-	-	-	-	-	-	-	28	28	28	28	28
NMRV 130	112B5	180	-	215	-	250	-	-	28	28	28	28	28	28	28	28	28	28	-
	132B5	230	-	265	-	300	-	-	38	38	38	38	38	38	38	38	38	-	-
	90B5	130	-	165	-	200	-	-	-	-	-	-	-	-	-	-	-	-	24